

Three Compartment Sink Set-Up

*Fill one sink at a time

**Do not dilute solution with additional water

Fill Wash Sink*

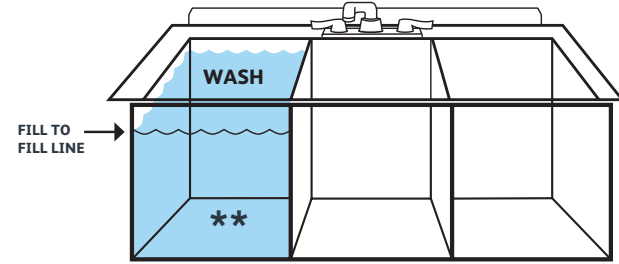

Fill Rinse Sink*

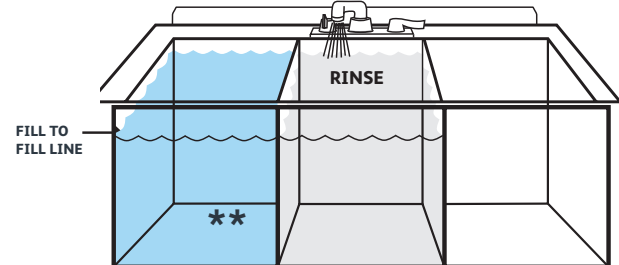

Fill Sanitize Sink*

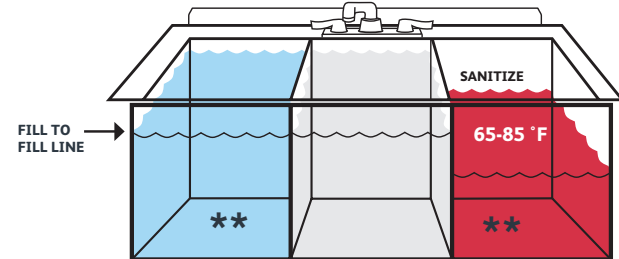

Operating Instructions



Open cap



Squeeze to measure

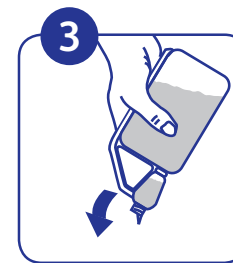

Pour

Cleaning Procedure



Scrape



Wash



Rinse

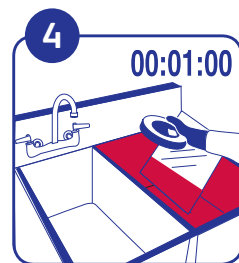

Sanitize
1 Minute

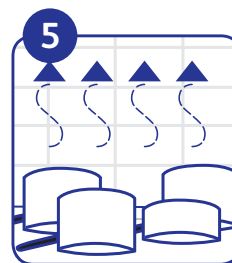

Air Dry

Sanitizer Test Instructions

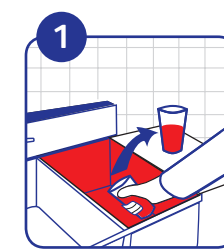

Obtain solution sample.

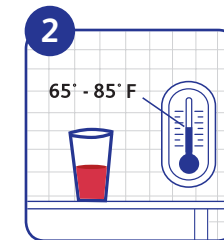

Solution must be between
65 - 85° F.

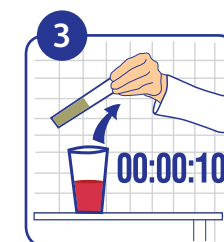

Dip test strip for 10 seconds.
Do not shake or swirl.
Compare colors immediately.

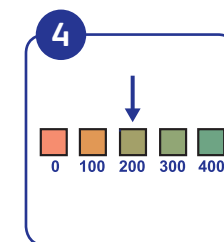

Test strip QT10 should read
200 ppm.

Supplies Needed



Fill Sink with **Suma Pan Clean^{™/MC}** from AccuMix bottle. Mix one full spout and fill left compartment of sink to fill line (5 gallons) with hot water.



Fill Sink with **J-512^{™/MC} Sanitizer** from AccuMix bottle. Mix one full spout and fill right compartment of sink to fill line (4 gallons) with cool water.



QT-10
Test Strips

Questions: 1-800-558-2332

Scan the QR code for
Accumix instructions

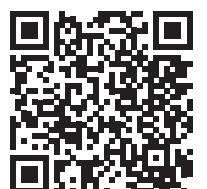

Disposición para fregaderos de tres compartimentos

* Llene un fregadero por vez

** No diluya la solución con agua adicional

Llene el fregadero de lavado*

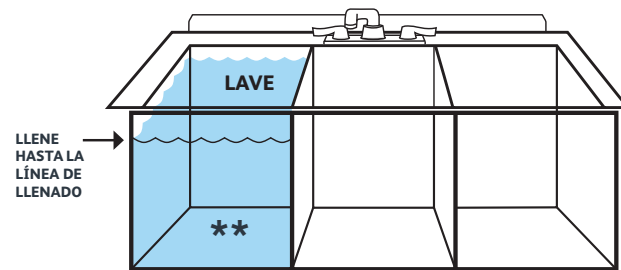

Llene el fregadero de lavado*

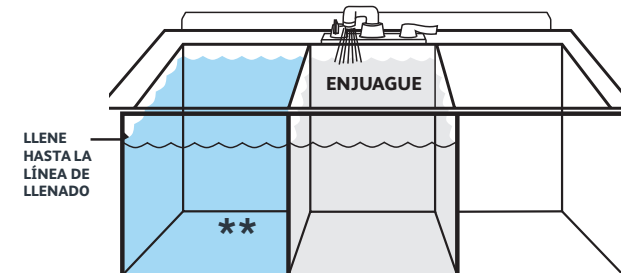

Llene el fregadero de desinfección*

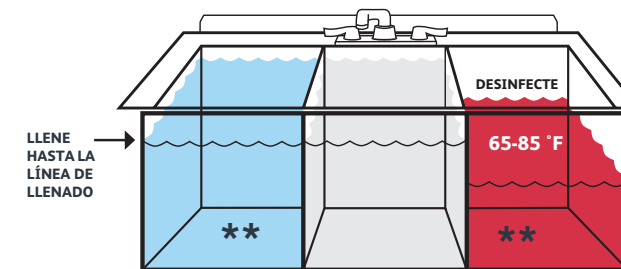

Instrucciones de funcionamiento



Abra la tapa



Apriete para medir



Vierta

Procedimiento de limpieza



Raspe



Lave



Enjuague

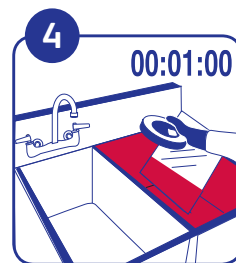

Desinfecte
1 minuto

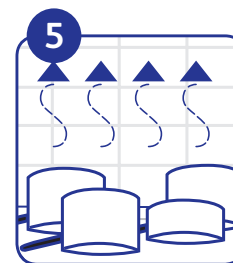

Deje secar
al aire

Instrucciones de prueba del desinfectante



Obtenga una muestra de la solución.

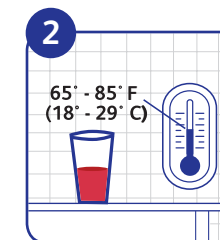

La solución debe estar entre 65 y 85 °F (18 y 29° C).



Sumerja la tira reactiva durante 10 segundos. No agite ni revuelva. Compare los colores inmediatamente

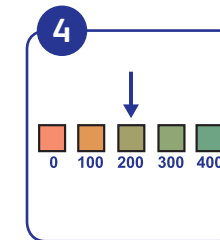

La tira reactiva QT10 debe indicar 200 ppm.

Suministros necesarios



Llene el fregadero con **Suma Pan Clean^{TM/MC}** de la botella AccuMix. Mezcle un pico lleno y llene el compartimento izquierdo del fregadero hasta la línea de llenado (5 galones) con agua caliente



Llene el fregadero con **Desinfectante J-512^{TM/MC}** de la botella AccuMix. Mezcle un pico lleno y llene el compartimento derecho del fregadero hasta la línea de llenado (4 galones) con agua fría.



Tiras Reactivas
QT-10

Preguntas: 1-800-558-2332

© 2019 Diversey, Inc. All Rights Reserved. 81197-CHT es (19/269)
*The hummingbird and wing shape logo is a trademark of Diversey, Inc.

Escanee el código QR para
Instrucciones de AccuMix

